



Medical Puncture Needle

Company Introduction

▶▶ Contents

Shanghai Kindly Enterprise Development Group Co., Ltd (hereafter referred to as KDL) now administer 12 companies as Shanghai Kindly Enterprise Development Group Medical Instruments Co., Ltd, Shanghai Kindly Enterprise Development Group Pharmaceutical Co., Ltd, Shanghai Kindly Medical Devices Automation Research Institute, Shanghai Kindly Tube Co., Ltd, Shanghai Kindly Teshima CO., Ltd, Shanghai Kindly International Trade Co., Ltd, Zhejiang Kindly Medical Devices Co., Ltd, Wenzhou Kindly Medical Devices Co., Ltd, Zhuhai Kindly Medical Devices Co., Ltd, Guangzhou Kindly Medical Devices Co., Ltd and Nanchang Kindly Medical Devices Co., Ltd

As one of the biggest manufacturers for medical polymer product in China, based on the quality principle "To win universal confidence with KDL quality and reputation", KDL provides the customers from more than fifty countries worldwide with the advanced medical products and service in the fields of medical puncture devices, intervention devices, medical high polymer devices, medical package, medical supply chain and so on. For the six consecutive years, KDL has been classified as Top Hundred Private Enterprises and Sci-Tech Giant Business in Shanghai. The disposable medical high polymer devices produced by KDL have been named as High-quality Medical Device Products and Famous Brand products in Shanghai, as well as the Excellent Brand Product by national industry association.

KDL insists on adopting production combined with education and research as the technical innovation strategy, and has established beneficial cooperation with some famous national universities as the important support of company's technical development. KDL is classified as Shanghai High-tech Enterprise, Shanghai Torch Plans, Shanghai High-tech Achievement Transformation Project, Shanghai Innovation Enterprise, Shanghai Patent Invention Award etc.

In terms of industry position, KDL does not only draw up four national standards for Disposable Syringes, Needles, Cannulas and Scalp Vein Sets, but also draft industry standards for Dental Needles, Blood Collection Needles and I.V Catheter. KDL's professional technicians act as the chairman of National Medical syringe (needle) Standardization Technical Committee and vice chairman of National Medical Infusion Set & Transfusion Set Standardization Technical Committee. KDL has also been nominated as the vice president of China Association for Medical Devices Industry (CAMDI) and the president of Medical Polymer Product Branch in CAMDI.

Medical Needle

Cosmetic Needle	01/02
Irrigation Needle	03/04
Bone Marrow Biopsy Needle	05/06
Huber Needle	07/08
Seldinger Needle	09/10
Chiba Needle	11/12
Anaesthesia Needles	13
Hair Implant Device	14

The Needle Tube

The Needle Tube	15
Biopsy Needle Tube	16
Veress Needle Tube	17
Seldinger Needle Tube	18
Gradient Diameter Needle	19
Bone Marrow Biopsy	20
Blind Tip Needle Tube	21
Blunt Tip Needle Tube	22
Special Needle Tube	23/24



Cosmetic Needle

Structure and composition:

The cosmetic needle consist of needle hub, needle tube Protective cap.

Material:

PP,SUS304 Stainless Steel Cannula,Silicone oil.

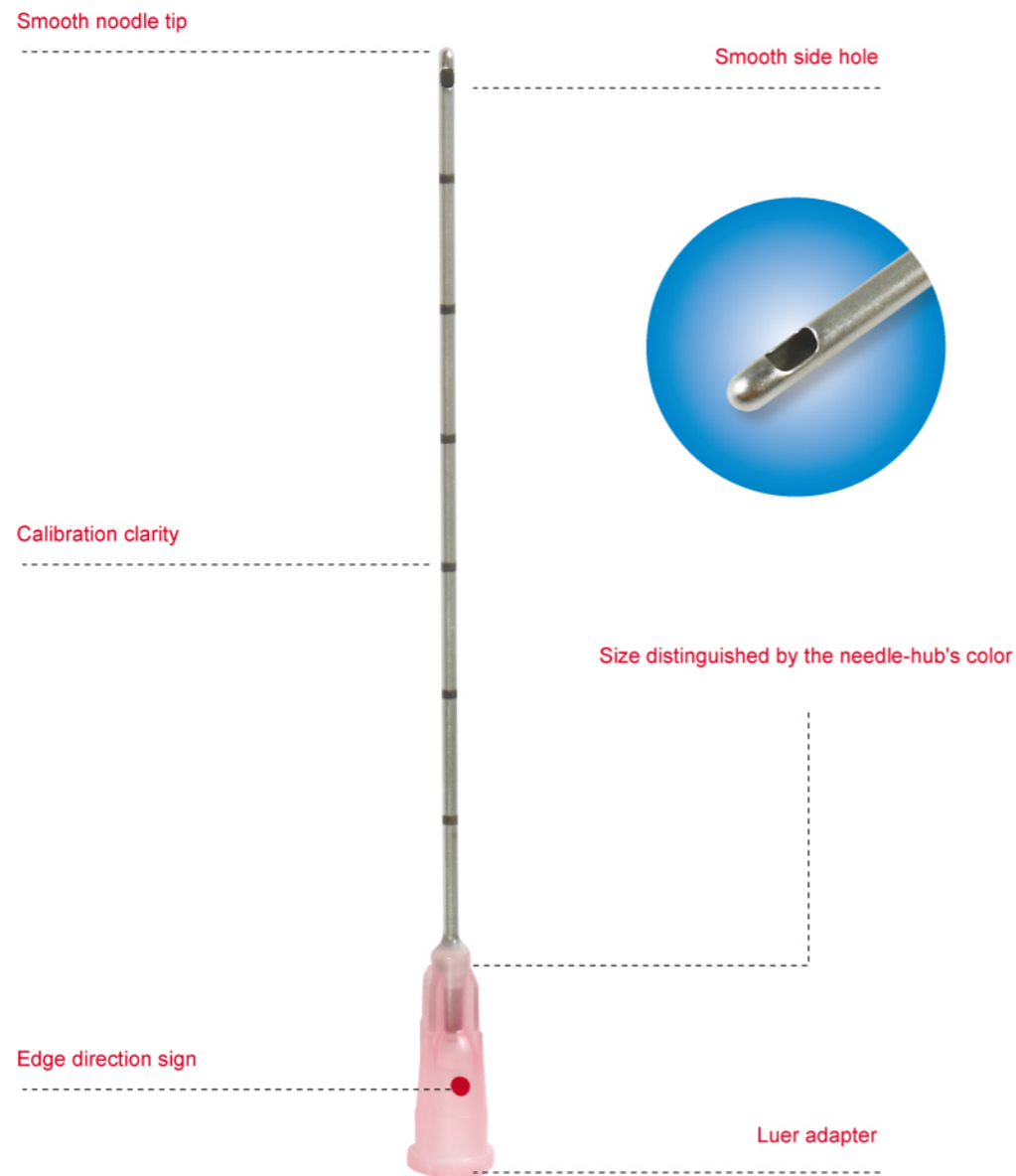

Intended use:

The Cosmetic Needles is used for special injection tasks such as injecting filling material in Plastic surgery.

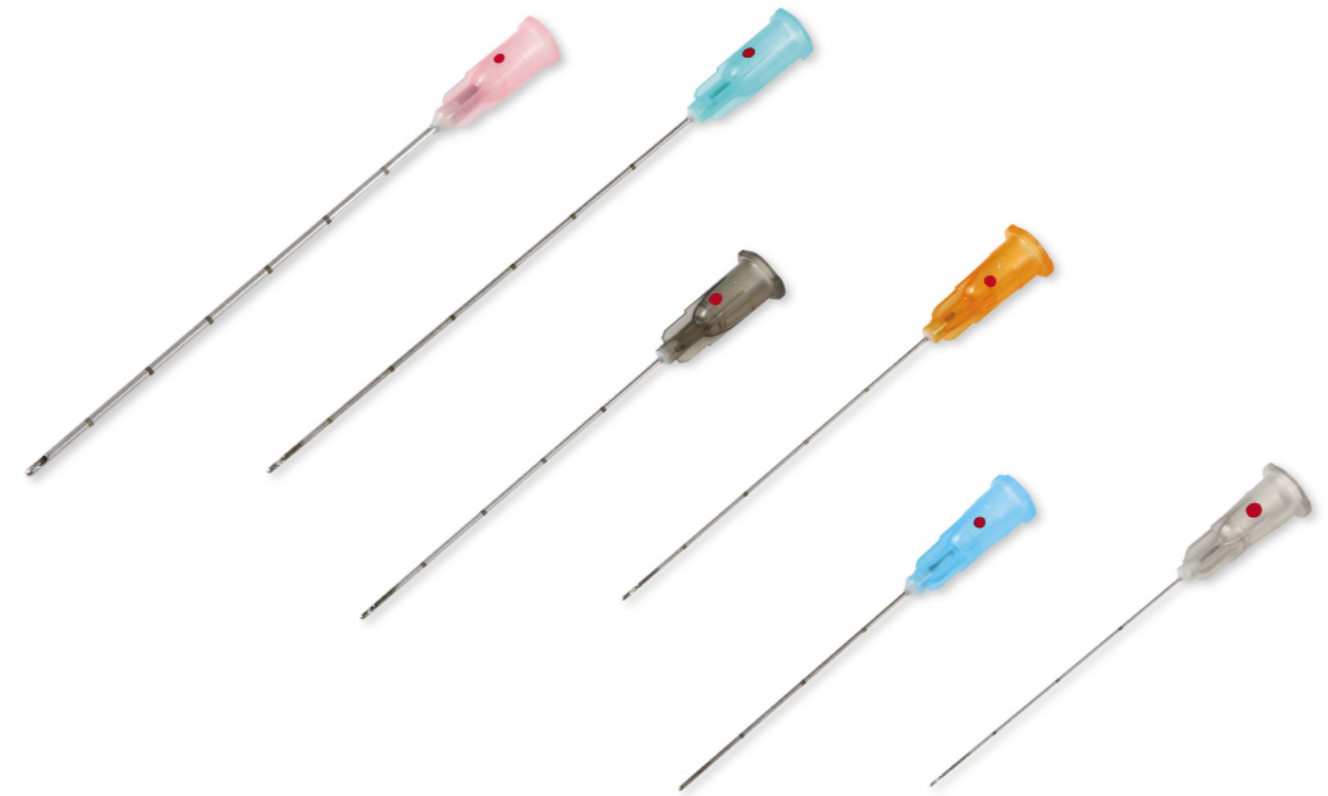

Specifications	
1.2×70 TW	0.5×50 TW
0.7×70 TW	0.5×40 TW
0.7×50 TW	0.4×40 TW
0.7×40 TW	0.3×25 RW
0.6×50 TW	0.25×25 RW

Remark: The type can make as clients' request.

Irrigation Needle

Structure and composition:

The Irrigation needle consist of needle hub, needle tube Protective cap.

Material:

PP, SUS304 Stainless Steel Cannula, Silicone oil.

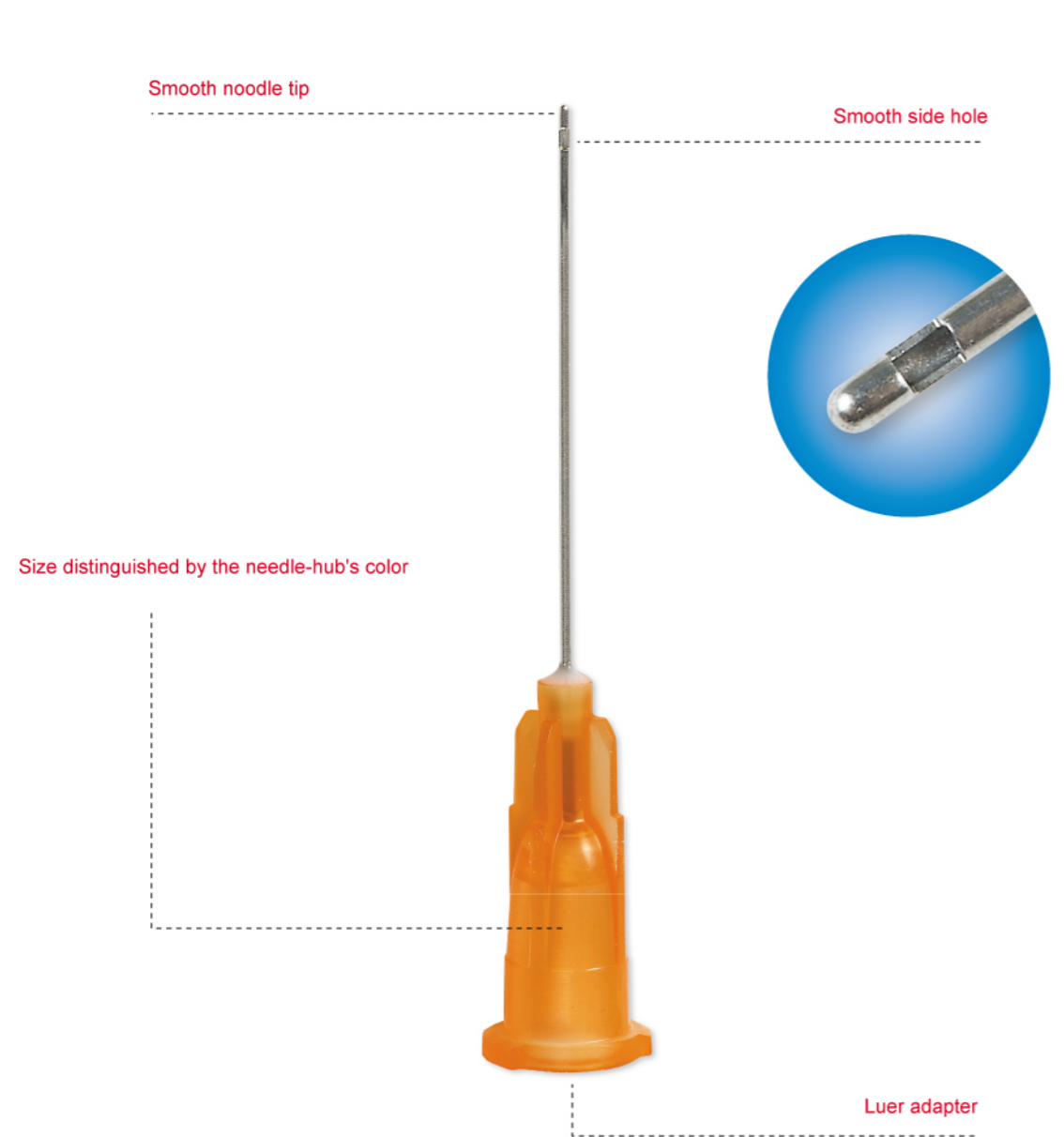

Remark: The type can make as clients' request.

Intended use:

The irrigation Needle is used for irrigation in dentistry and ophthalmology.



Specifications:

According to the shape of the needle tip, it is divided into three types: flat head, pointed head and round head: according to whether the needle tube is bent, it is divided into straight shape and curved shape. According to the nominal diameter of the needle tube: 14G~30G.



Bone Marrow Biopsy Needle

Structure and composition:

The Bone marrow biopsy needle consist of needle hub, needle tube, lining core, handle and Protec tive cap.

Material:

ABS,PP,PC, SUS304 Stainless Steel Cannula,Silicone oil

Intended use:

The Bone marrow biopsy needle is used for bone marrow aspiration.

Digital scale can provide accurate puncture depth.

Multiple edge

The edge is strong and sharp, that allows a quick and less invasive penetration into the cortical

Special trocar needle and sharp tubing ensure minimal invasion, 5 side holes at front end of tubing,multi-way collect bonemarrow, more efficient and less pain.

The handle includes a sharpened luer-lock which gives a safer Attachment to the syringe. Aspiration can be performed at any Step of the procedure.

Pick up needle is provided with a rotation coupling security system which limits the risk of movement of the stylet during the insertion.

Provide one more needle, ensure sharpness and less pain when multi-point invasion

Specification

SIZE		LENGTH			
OD(mm)	GAUGE	70 2 3/4"	90 3 1/2"	110 4 1/4"	130 5"
1.8	15G	✓		✓	
2.5	13G	✓		✓	✓
3.0	11G		✓		

Remark: normal size in above table, we can also make special aize as clients' request.

Remark: The type can make as clients' request.

Huber Needle

Structure and composition:

The huber needles are assembled by protective cap, needle hub, needle tube, tubing, injection site, robert clamp and other parts. All materials meet medical requirement, sterilized by ETO, pyrogen-free.

Material:

PC,PP,PVC, SUS304 Stainless Steel Cannula, Silicone oil

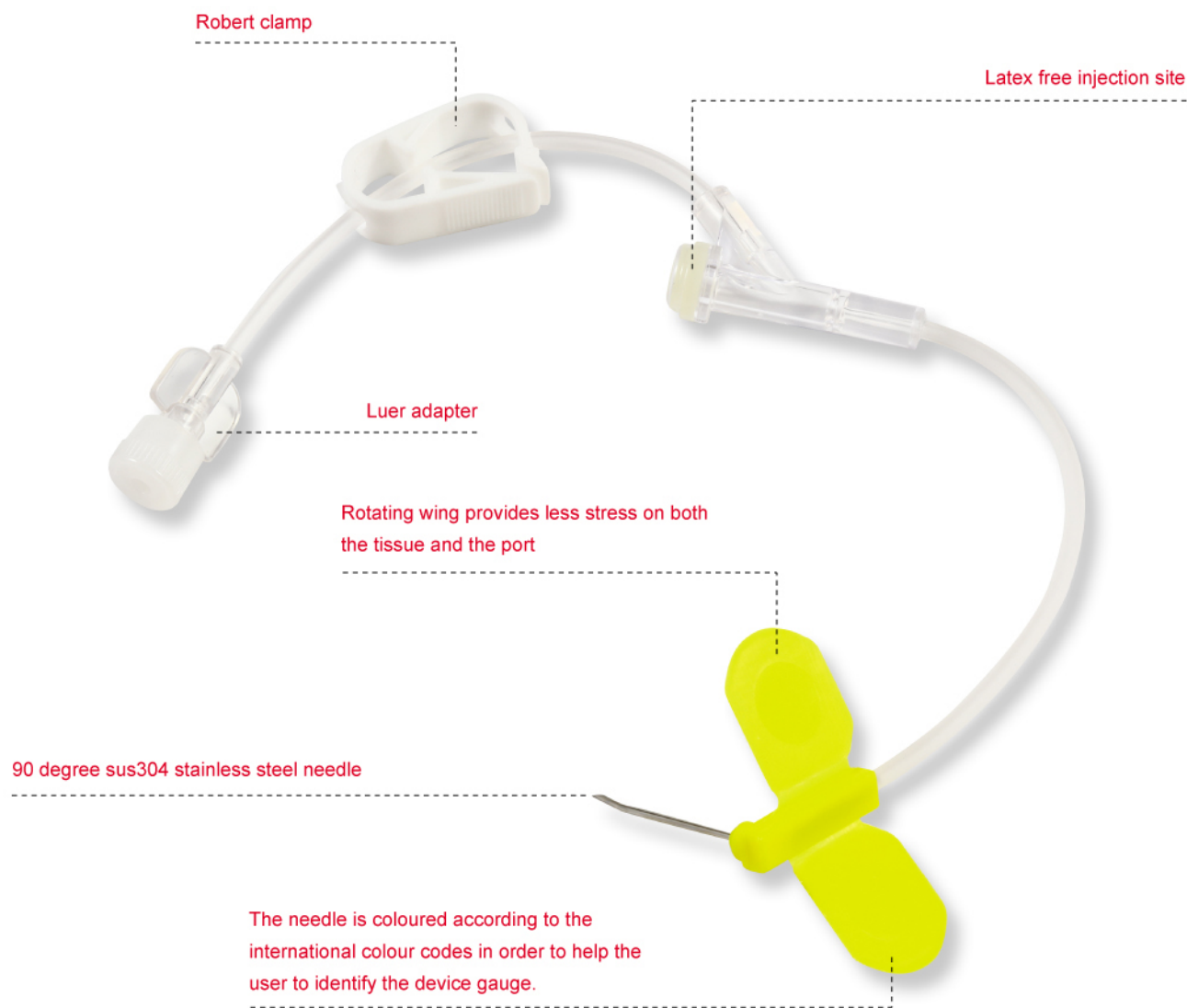

Remark: The type can make as clients' request.

Intended use:

The huber needle is intended to be used to feed medicine to the device implanted in patient hypoderm.

Detailed specifications

OD (mm)	SIZE GAUGE	COLOR COLOR & CODE	LENGTH						ID		Bevel angle			
			1/3"	1/2"	5/8"	3/4"	1"	1 1/4"	1 1/2"	2"	RW	TW	Long bevel	Short bevel
0.70	22G	black												
0.80	21G	green												
0.90	20G	yellow												
1.10	19G	cream												

Remark: normal size in above table, we can also make special size as clients' request.



Seldinger Needle

Structure and composition:

The seldinger needle consist of needle hub, needle tube Protective cap. All materials meet medical require ment, sterilized by ETO, pyrogen-free.

Material:

PC,PP, SUS304 Stainless Steel Cannula,Silicone oil

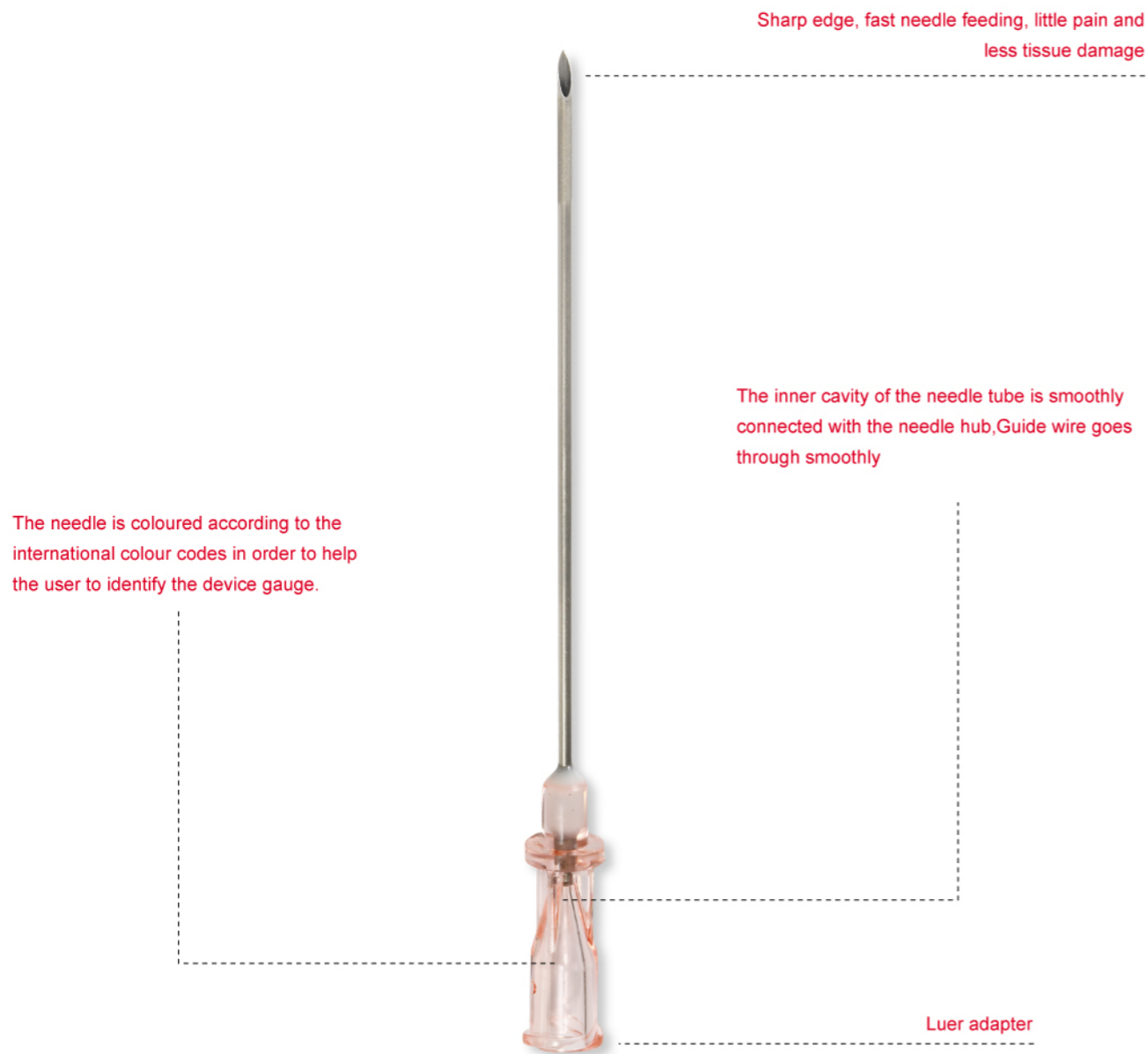

Intended use:

The seldinger needle is used to penetrate into artery vas at the beginning of the intervention operation, and then introduce the guidewire into the vas.

Detailed specifications

Specifications	Length
14G ~25G	90mm、150mm、200mm

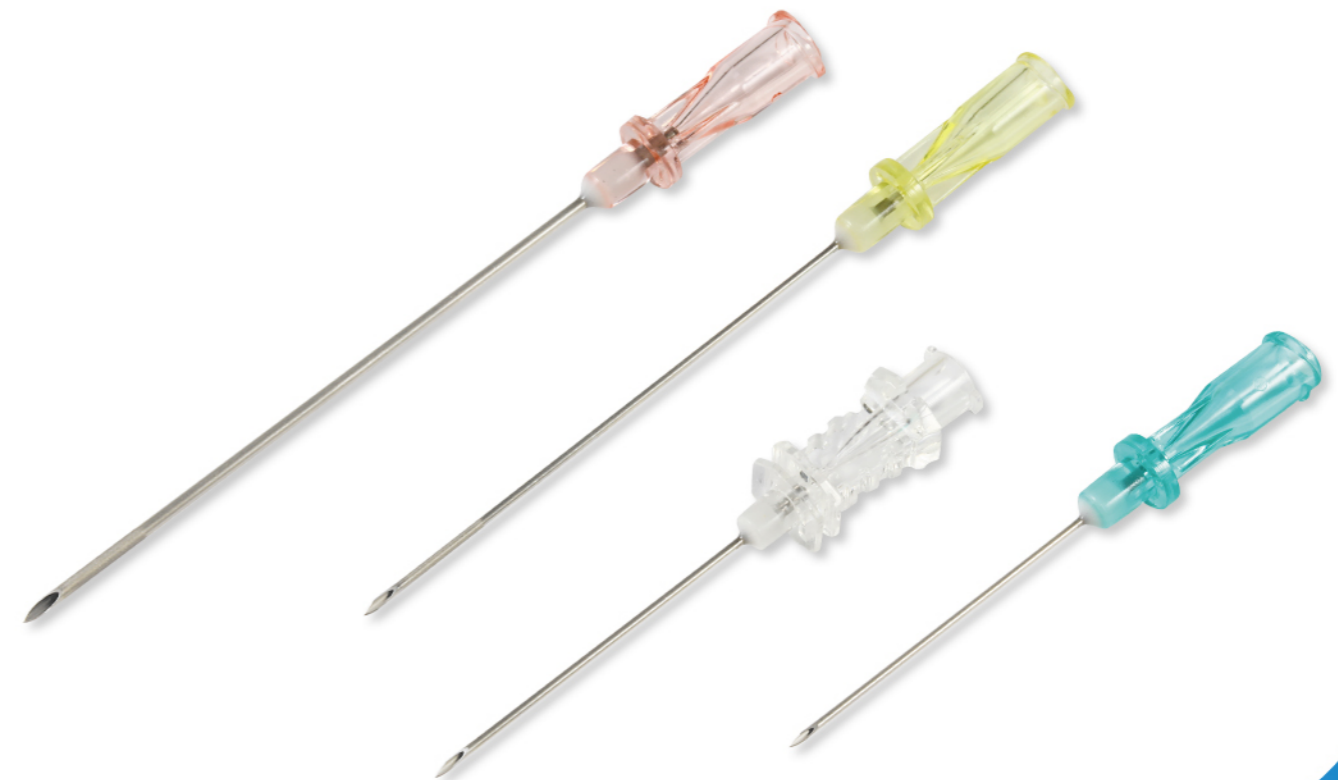

Remark: The type can make as clients' request.

Chiba Needle

Structure and composition:

The chiba needle consist of needle hub, needle tube Protective cap. All materials meet medical require ment, sterilized by ETO, pyrogen-free.

Material:

PC,PP, SUS304 Stainless Steel Cannula,Silicone oil

The internal echogenic marker on the tip enables a correct placement of the needle and its constant visualization under ultrasound guidance.

Centimeter markings on the cannula surface enhance an easy determination of the insertion depth with the maximum safety for the patient.

Sharper tip design for easy puncture operation

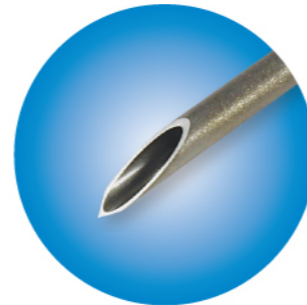
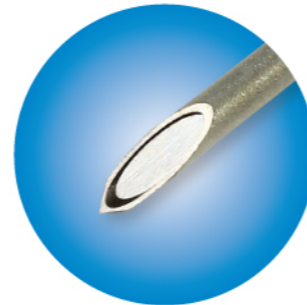

The needle is coloured according to the international colour codes in order to help the user to identify the device gauge.

Remark: The type can make as clients' request.

Intended use:

The Chiba needle iis used to inject drugs, necessary tools for lower guide wire and take liquid cell tissue fluid.

Detailed specifications

Specifications	Length
18G	90mm、150mm、200mm
20G	90mm、150mm、200mm
22G	90mm、150mm、200mm



Anaesthesia Needles

Structure and composition:

The Anaesthesia needles consist of needle hub, needle tube (out), needle tube (inner), pro tector cap. Major categories: Spinal anesthesia needles, Epidural anesthesia needles, Combined anaesthesia needles.

Material:

PP,PC,ABS, SUS304 Stainless Steel Cannula,Silicone oil.

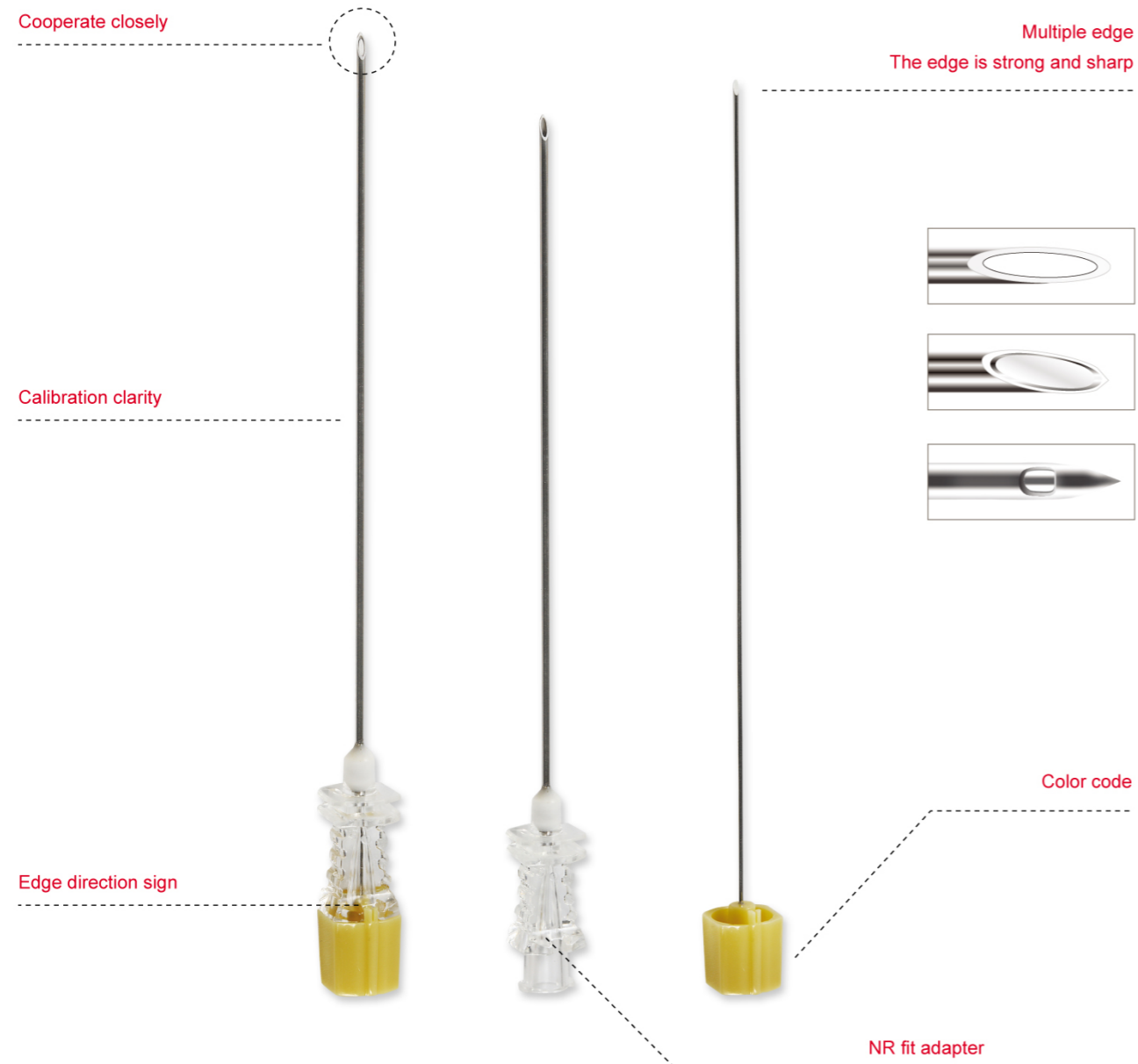

Remark: The type can make as clients' request.

Hair Implant Device

Structure and composition:

The Hair implant needle consist of needle hub, needle tube Protective cap. All materials meet medical require ment, sterilized by ETO, pyrogen-free.

Material:

PP, SUS304 Stainless Steel Cannula,Silicone oil

Intended use:

The Hair implant needle is used for single hair follicle transplantation. The hair follicle is directly inserted into the skin for implantation.

Specifications:

19G, 20G,21G

Sharper tip design for easy puncture operation

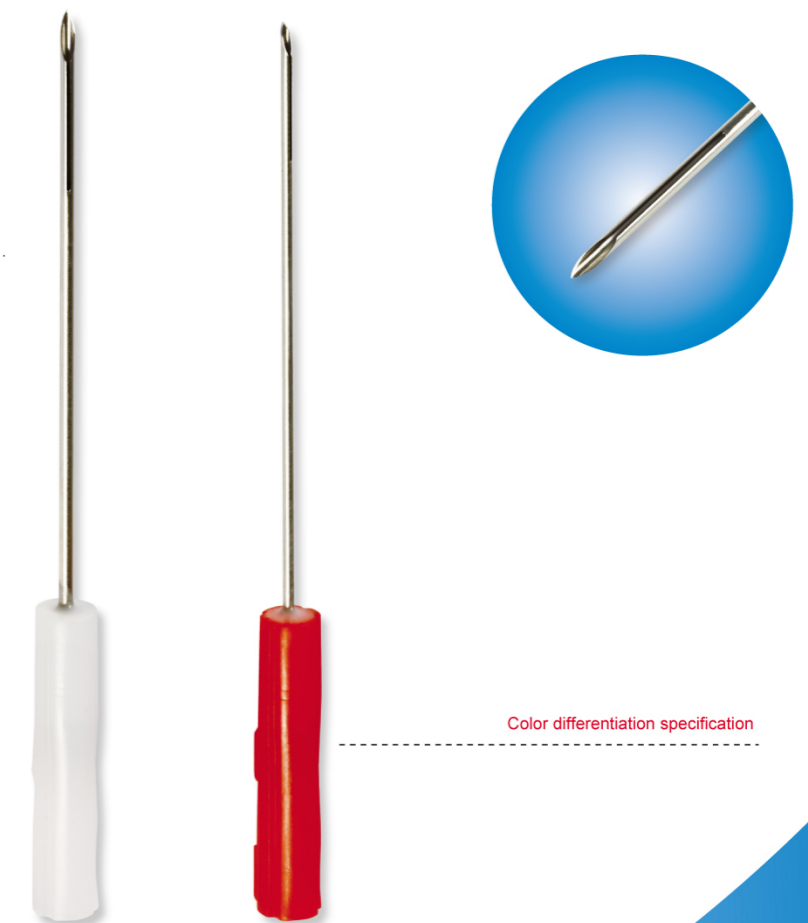

The Needle Tube

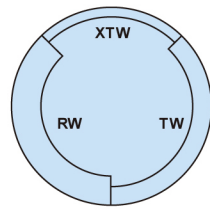

Comparison between
Regular Wall,
Thin Wall
and Extra Thin Wall

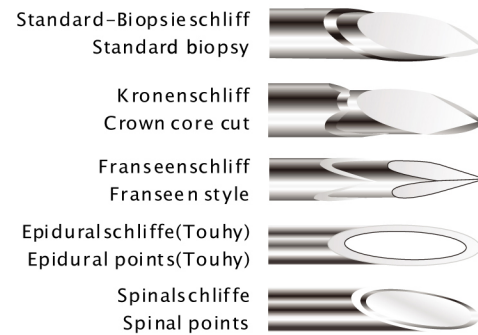
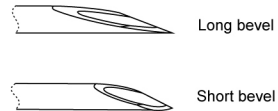

Shanghai Kindly Enterprise Development Group Co., Ltd. The company specializes in the production of stainless steel capillary and special-shaped puncture needles. It has complete sets of special equipment and mature production process from stainless steel welded pipe to special-shaped puncture needle forming. Stainless steel tube specification range: outer diameter 0.3mm-4.0mm; tube wall 0.06-0.35mm, the production of stainless steel tube can reach the inner and outer tube wall light shell, the products are widely used in medical electronics and other fields. The company has a number of technical backbones who are good at making special-shaped puncture needles, and can customize a variety of special-shaped needles according to customers' special requirements.

GAUGE	Size Nominal	Outer diameter		Inner diameter		
		min	max	Regular wall	Thin wall	Extra thin wall
				min	min	min
30	0.30	0.298	0.320	0.133	0.165	
29	0.33	0.324	0.351	0.133	0.190	
28	0.36	0.349	0.370	0.133	0.190	
27	0.40	0.400	0.420	0.184	0.241	
26	0.45	0.440	0.470	0.232	0.292	
25	0.50	0.500	0.530	0.232	0.292	
24	0.55	0.550	0.580	0.280	0.343	
23	0.60	0.600	0.650	0.317	0.370	0.460
22	0.70	0.698	0.730	0.390	0.440	0.522
21	0.80	0.800	0.830	0.490	0.547	0.610
20	0.90	0.860	0.920	0.560	0.635	0.687
19	1.10	1.030	1.100	0.648	0.750	0.850
18	1.20	1.200	1.300	0.790	0.910	1.041
17	1.40	1.400	1.510	0.950	1.156	1.244
16	1.60	1.600	1.690	1.100	1.283	1.390
15	1.80	1.750	1.900	1.300	1.460	1.560
14	2.10	1.950	2.150	1.500	1.600	1.727
13	2.40	2.300	2.500	1.700	1.956	
12	2.70	2.650	2.850	1.950	2.235	
11	3.00	2.950	3.150	2.200	2.464	
10	3.40	3.300	3.500	2.500	2.819	

Biopsy Needle Tube

Use for the production of biopsy needle, it can be customized according to the requirements of customers.

It is made of high-quality steel, with sharp cutting needle, high rigidity, good coordination, accurate and complete sampling, and clear reflection imaging under B-ultrasound.

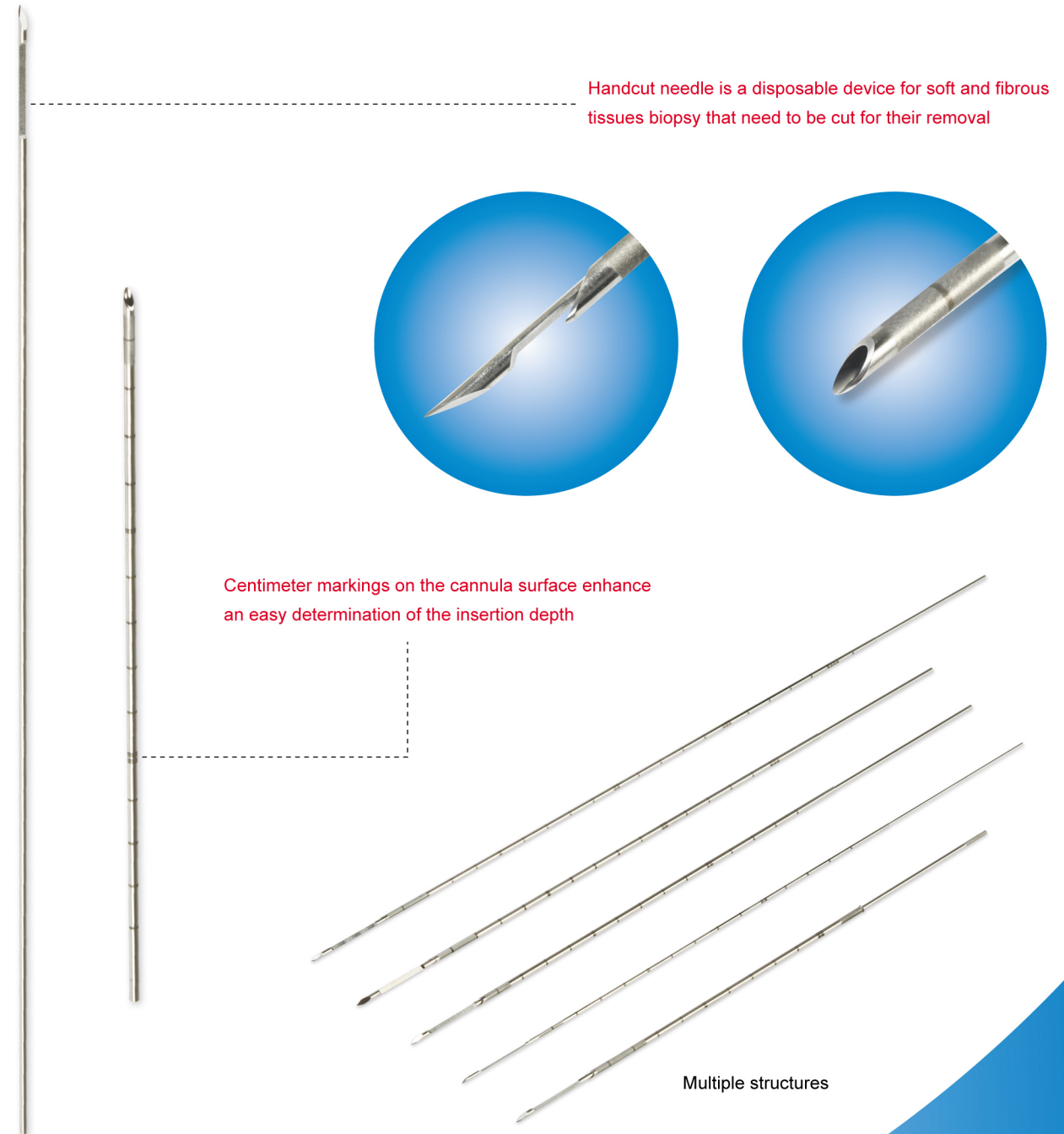

Remark: The type can make as clients' request.

Veress Needle Tube

For veress needle production, can be customized according to customer requirements.

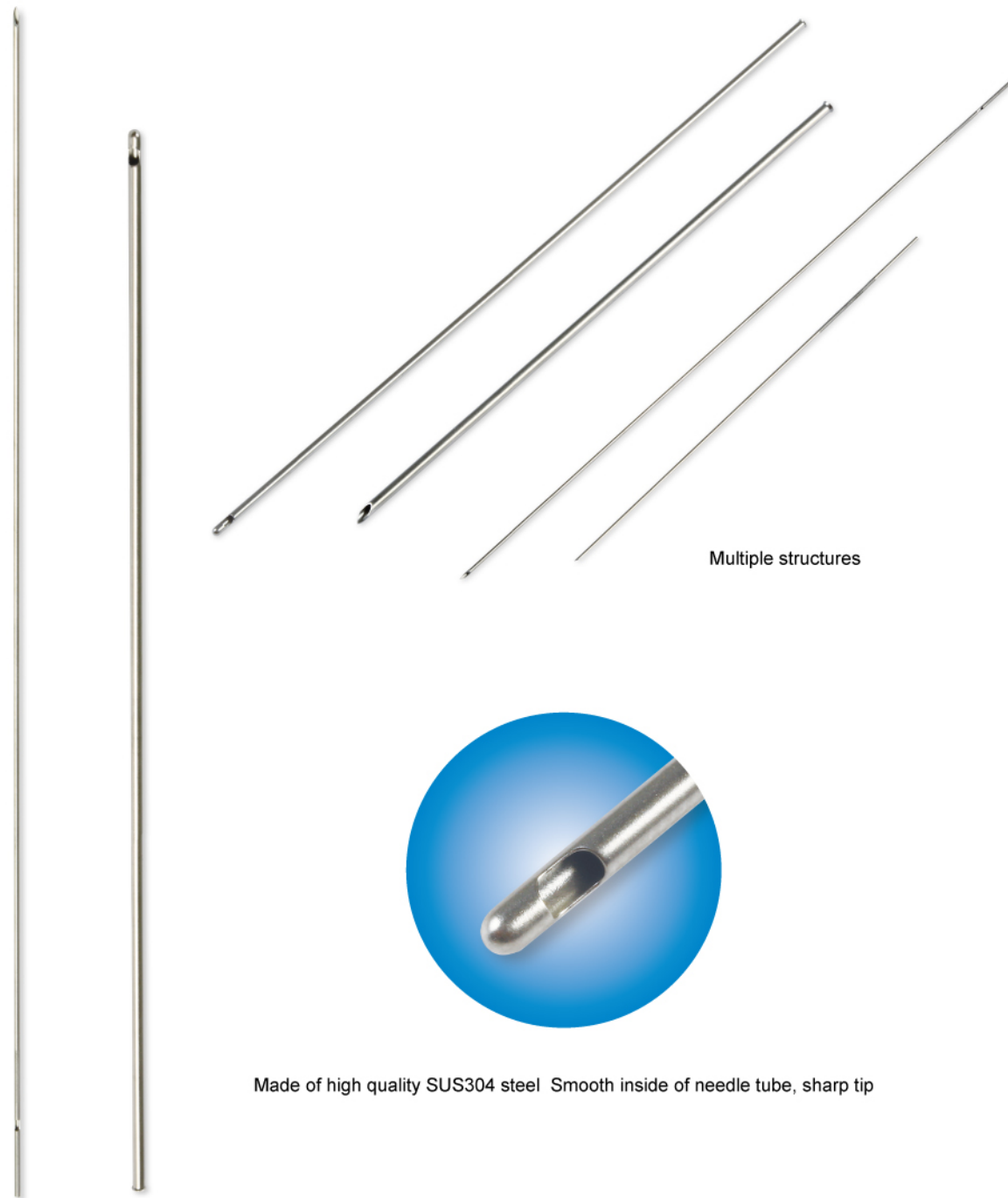

Made of high quality SUS304 steel Smooth inside of needle tube, sharp tip

Remark: The type can make as clients' request.

Seldinger Needle Tube

For seldinger needle production, can be customized according to customer requirements.

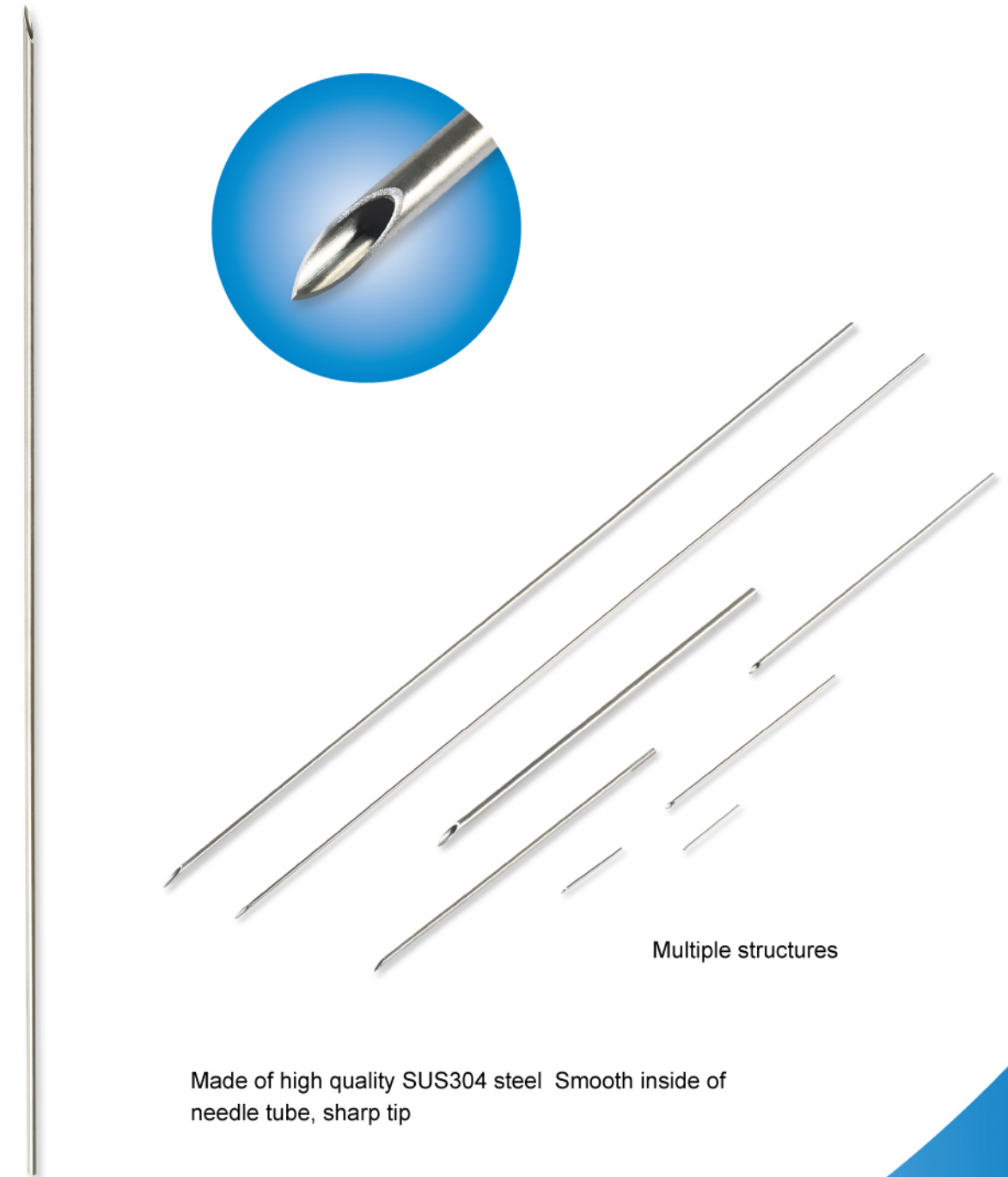

Made of high quality SUS304 steel Smooth inside of
needle tube, sharp tip

Remark: The type can make as clients' request.

Gradient Diameter Needle

Gradient Diameter needle tube use for Ovum Aspiration Needle production

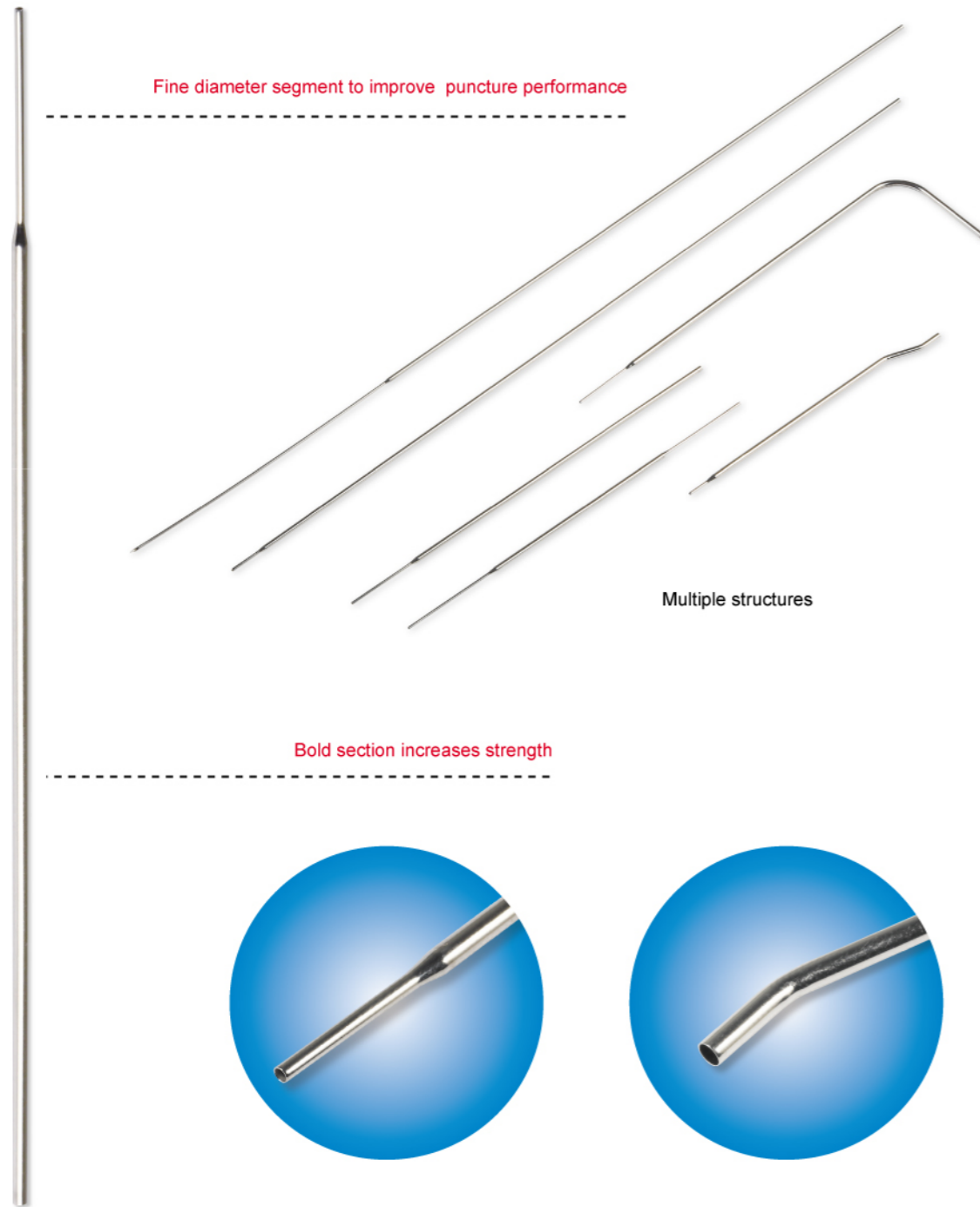

Remark: The type can make as clients' request.

Bone Marrow Biopsy

Use for the Bone marrow biopsy needle production, It is made of high-quality steel, with sharp cutting needle, high rigidity, good coordination.

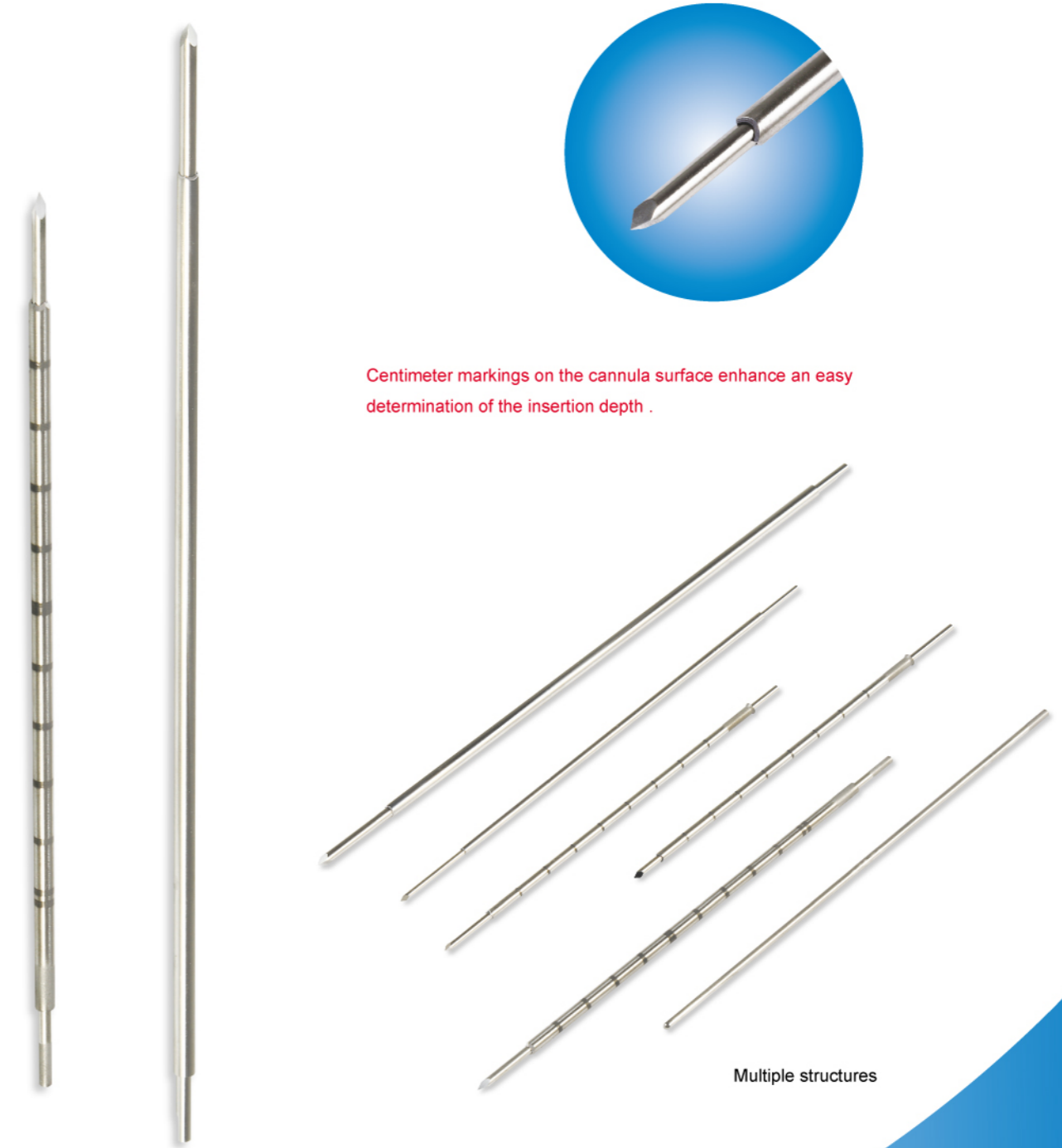

Blind Tip Needle Tube

Mainly used in the production of exhaust needle

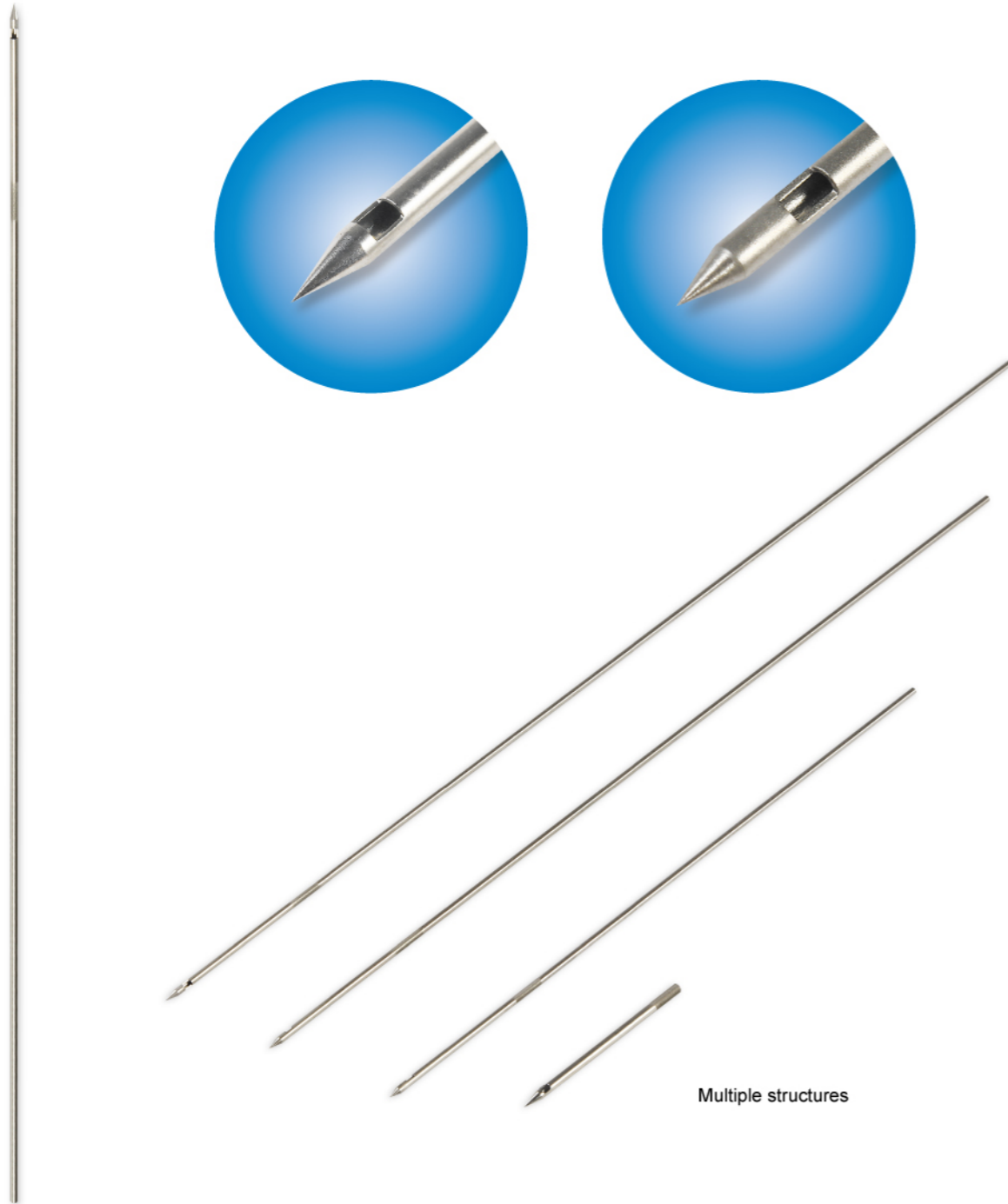

Multiple structures

Remark: The type can make as clients' request.

Blunt Tip Needle Tube

Mainly used in the production of the syringe that can through the guide wire

There is no burr in the hole, and the inner hole is smooth.



Special Needle Tube

All kinds of special needle can be customized

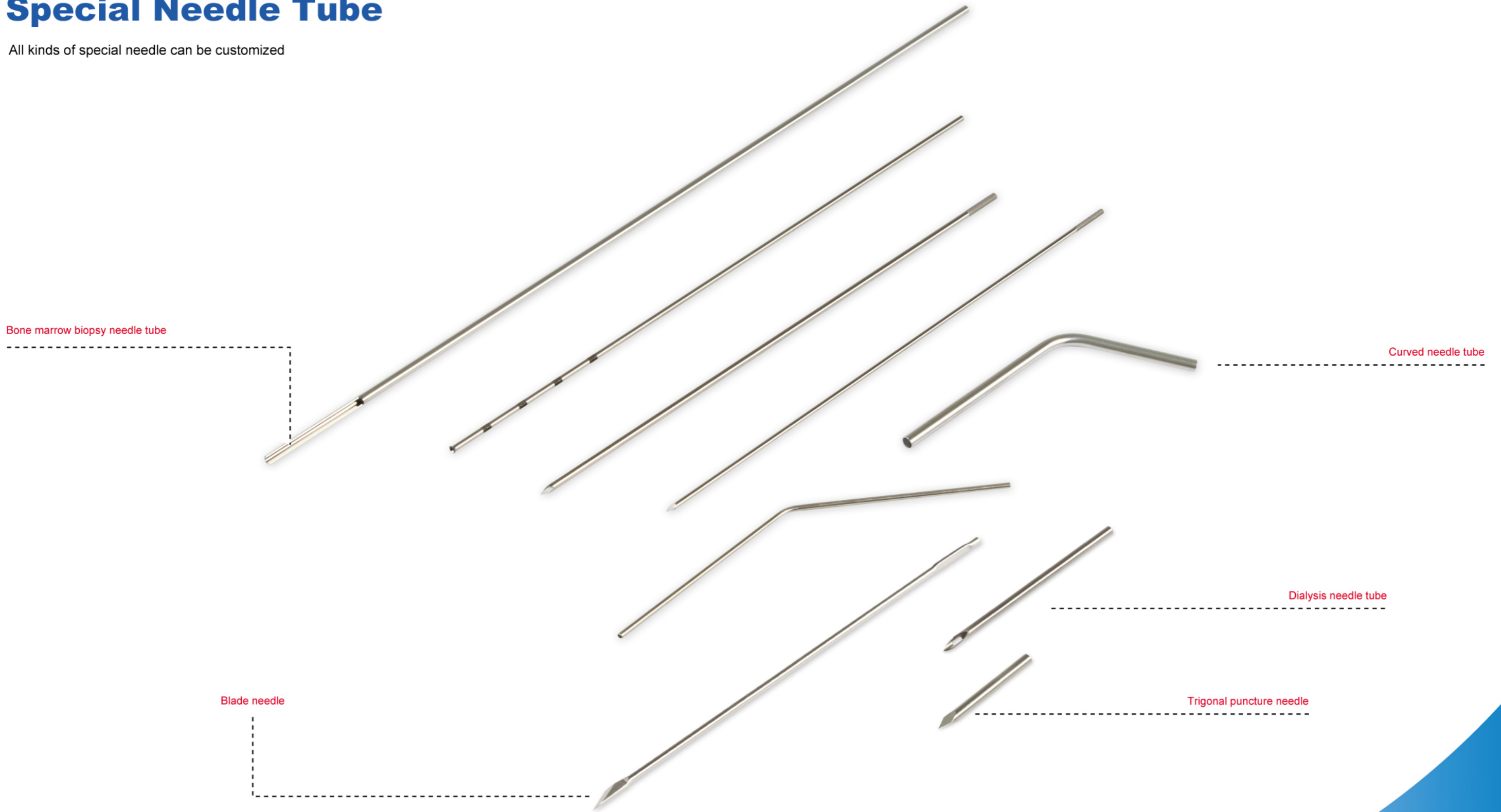

Remark: The type can make as clients' request.